



**TENEO**  
CONNECTING SOLUTIONS

# MOG<sup>SERIES</sup>

single pole heavy duty  
power connectors



**PRODUCT CATALOGUE**

v12 2022





- 2 BASIC PARAMETERS
- 3 - 4 BASIC OVERVIEW
- 5 - 6 PRINCIPLE OF CREATING THE ORDER CODE
- 7 - 8 STRAIGHT PLUG ASSEMBLIES (MOG-10)
- 9 - 10 IN-LINE RECEPTACLE ASSEMBLIES (MOG-15)
- 11 - 12 PANEL MOUNT RECEPTACLE ASSEMBLY (MOG-17)
- 13 INSERT CONFIGURATION & BACKSHELL STYLE
- 14 YOUR NOTES



BASIC PARAMETERS

The TENEО MOG single pole power connector series are designed to withstand the rugged environment of the Marine, Oil and Gas industry.

MOG series provides the highest level of quality, efficiency, reliability, and safety for the oil field power distribution use.

Connectors excels due to proven, secured locking coupling system an accessible, replaceable contact system that rivals other similar power connectors. This product line is 100% interchangeable with well-known brands, as well as custom contact designs.

This series is available for hazardous location protection and general environment usage. All Single Pole MOG connectors are UL & CSA certified and meet IP 68 requirements.

- ENVIRONMENTAL RATING  
**IP68**
- TEMPERATURE RATING  
**-55 °C to +40 °C**
- RELATIVE HUMIDITY  
**95 %**
- CHEMICAL RESISTANCE  
**Oil & most Acids & Alkalis**
- CORROSION RESISTANCE IN SALT SPRAY  
**500 days**
- SHOCK RESISTANCE  
**> 60 G / certain inserts available to 200 G**
- VIBRATION RESISTANCE  
**MIL-STD-167-1 & Method II**
- DUST RESISTANCE  
**MIL-STD-202B, Method 110, Cond. B**

- PIN RATED CURRENT IN  
**225 – 1050 A**
- OPERATING VOLTAGE  $U_n$   
**1000 V**
- CONTACT RESISTANCE OF A CONTACT PAIR  
**0,015 – 0,03 mΩ**
- INSULATION RESISTANCE UNDER NORMAL CLIMATE  
**≥ 1 GΩ**

- CONNECTOR DIAMETER  
**88 mm**
- NUMBER OF CONTACTS  
**1 piece**
- WIRE CROSS SECTION  
**313 – 777 MCM**
- CONNECTION TO WIRE  
**Crimping / Bus Bar**
- NUMBER OF CONNECTIONS / DISCONNECTIONS  
**500**

- EXTERNAL PRESSURE (COUPLED CONNECTORS)  
**2,0 MPa**
- INTERNAL PRESSURE (WITH PIN & SOCKET INSERTS)  
**1,4 MPa**

BODY STYLE

INSERT CONFIGURATION

STRAIGHT PLUG ASSEMBLIES



**MOG-10-M**  
Straight Plug with  
Mechanical Clamp Nut  
page 8



**MOG-10-K**  
Straight Plug with  
Basketweave Cable Grip  
page 8



**MOG-10-D**  
Straight Plug with  
Standard Compression Nut  
page 8

IN-LINE RECEPTACLE ASSEMBLIES



**MOG-15-M**  
In-Line Receptacle with  
Mechanical Clamp Nut  
page 10



**MOG-15-K**  
In-Line Receptacle with  
Basketweave Cable Grip  
page 10



**MOG-15-D**  
In-Line Receptacle with  
Standard Compression Nut  
page 10

PANEL MOUNT RECEPTACLE ASSEMBLY



**MOG-17**  
Square Flange  
Panel Mount Receptacle  
page 12

**PINS**



Pin



Bus Bar Pin

**SOCKETS**



Socket



Bus Bar Socket



313 MCM



373 MCM



444 MCM



535 MCM



646 MCM



777 MCM

page 13

BODY COLOR



BACKSHELL STYLE



Standard  
Compression Nut



Mechanical  
Clamp Nut



Basketweave  
Cable Grip

MOG

-

10

P

7

-

30

-

M

-

BK

Only for variants  
MOG-10 and MOG-15

BODY  
STYLE

INSERT  
CONFIGURATION

CABLE  
SIZE

GROMMET  
SIZE

BACKSHELL  
STYLE

BODY  
COLOR

10

Straight Plug

15

In-Line Receptacle

17

Square Flange Panel Mount Receptacle

P

Pin

S

Socket

PR

Bus Bar Pin

SR

Bus Bar Socket

2

313 MCM

3

373 MCM

4

444 MCM

5

535 MCM

6

646 MCM

7

777 MCM

Look at the table  
page 13

Cable diameter  
code nr. 00

Grommet  
is not included

D

Standard Compression Nut

M

Mechanical Clamp Nut

K

Basketweave Cable Grip

BK

Black

BL

Blue

G

Green

Y

Yellow

OR

Orange

R

Red

BR

Brown

GY

Grey

W

White

Only for variants  
MOG-17

EXAMPLES

MOG-10P7-30-M-BK

MOG-17SR-R

MOG-15S7-30-M-W

5 MOG

www.teneo.cz 6



STRAIGHT PLUG ASSEMBLIES

MOG-10



**MOG-10-M**  
Straight Plug with  
Mechanical Clamp Nut



**MOG-10-K**  
Straight Plug with  
Basketweave Cable Grip



**MOG-10-D**  
Straight Plug with  
Standard Compression Nut

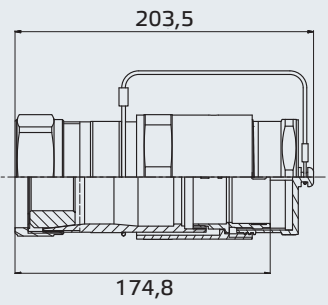
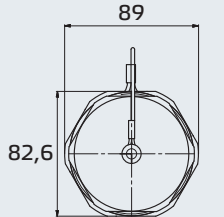
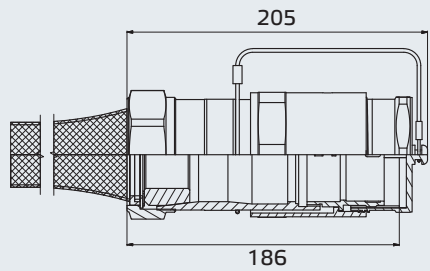
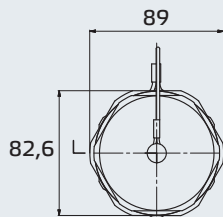
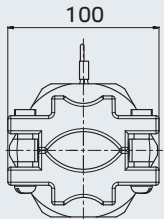
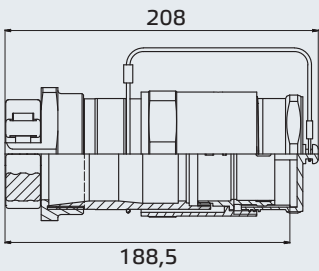
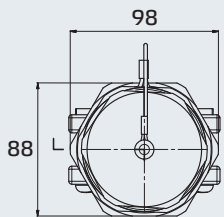



IN-LINE RECEPTACLE ASSEMBLIES

MOG-15



**MOG-15-M**  
In-Line Receptacle with  
Mechanical Clamp Nut

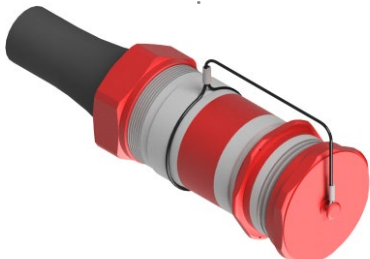

**MOG-15-K**  
In-Line Receptacle with  
Basketweave Cable Grip



**MOG-15-D**  
In-Line Receptacle with  
Standard Compression Nut

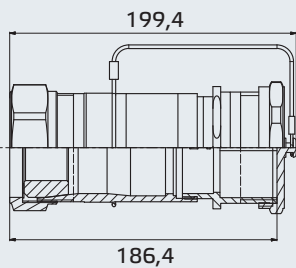
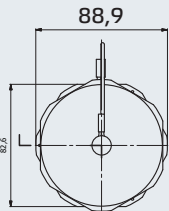
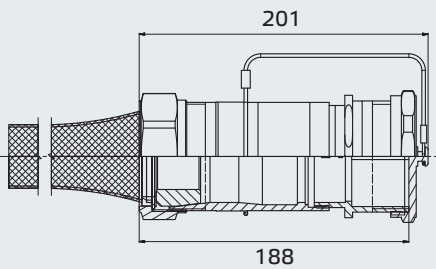
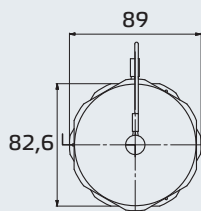
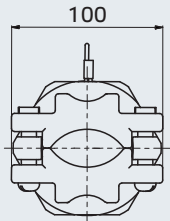
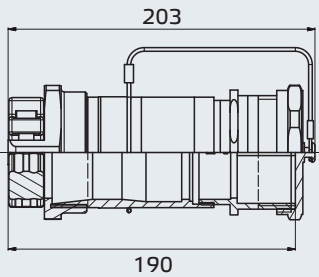
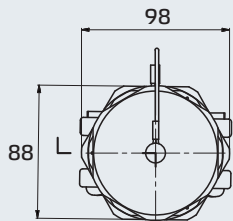





PANEL MOUNT RECEPTACLE ASSEMBLY

MOG-17

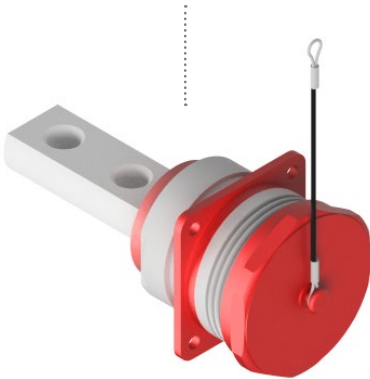

MOG-17  
Square Flange  
Panel Mount Receptacle

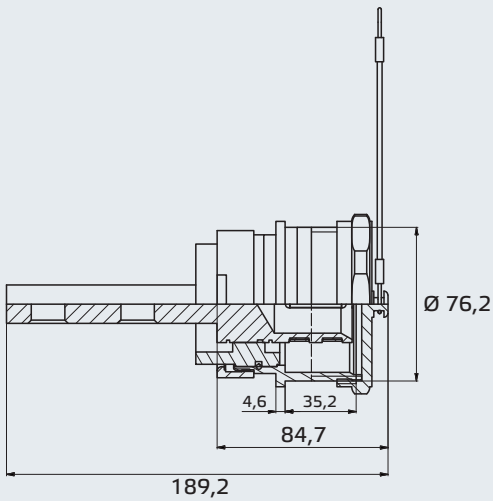
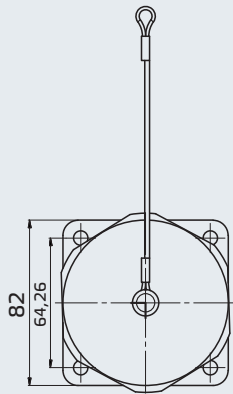



## YOUR NOTES

## BACKSHELL STYLE

13 **MOG**



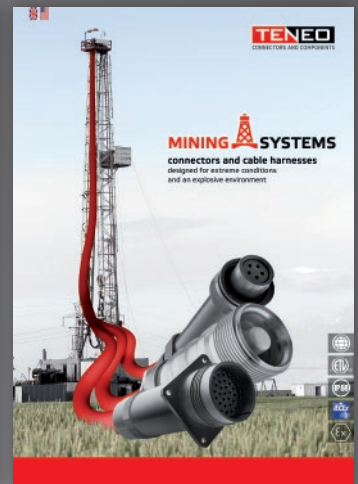

**ISO 14001**  
United Registrar  
of Systems



**ISO 9001**  
United Registrar  
of Systems



**ASSOCIATION MEMBER**  
Defence and Security  
Industry Association



**ECO FRIENDLY**  
ASEKOL a.s.  
Ecological Waste Disposal

